



## 2/12 Parkfront Terrace Waterford, QLD

 2  2  1

**SOLD by JAY ASTON | 0416 140 227**

ALL PROPERTIES GROUP & JAY ASTON SOLD?

- | "12 PARKFRONT" | 2/12 Parkfront Terrace, Waterford | -

Affordability at its Finest !!! This amazing first home/investment opportunity is now for Sale, Be Quick !!!!!

Set on a quiet leafy street, close to parklands, shopping precincts and schools this well-presented contemporary residence offers idyllic low maintenance and stylish lifestyle. Spaciously designed, the ground floor is dedicated to living and dining. Offering warm, neutral tones throughout this home offers a relaxed and elegant ambience with a well-designed and stylish kitchen.

downtime.

Features of this stylish property include:

- Spacious open plan kitchen/dining & living area
- Elegant Kitchen with breakfast bar and quality stainless-steel appliances
- Large laundry with additional toilet + internal access from remote garage
- Additional toilet on ground floor

\$255,000

**Type:** Unit

**Sold Date:** Saturday, 30th January 2021

**Land:** 115 m2

**Building Size:** 87 m2



**Jay Aston**

0416 140 227



**Josh Smith**

0401 584 058



2 x 2 x 1 x

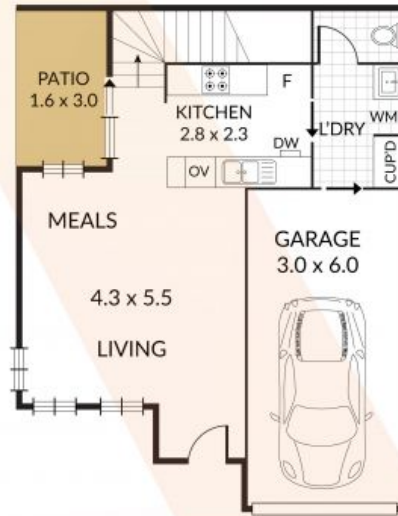
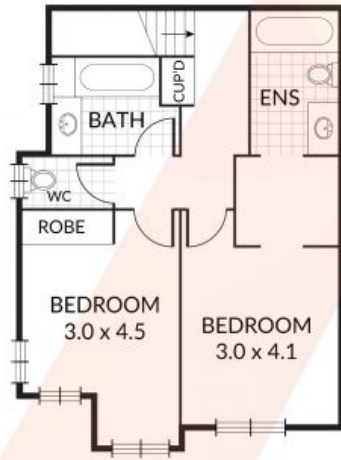

NOTE: Every precaution has been taken to verify the accuracy of the details. However, prospective purchasers are advised to make their own enquiries.

